

INSPECTION

HEAD LAMP RELAY

1. Pull out the relay from the engine compartment relay box.

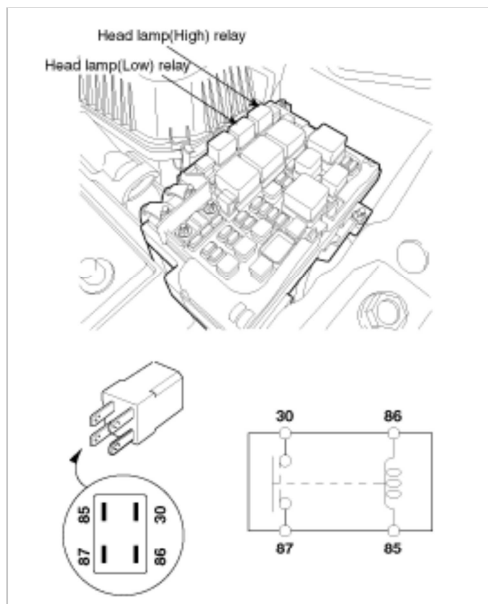

2. Check for continuity between terminals. There should be continuity between the No.87 and No.30 terminals when power and ground are connected to the No.86 and No.85 terminals.
3. There should be no continuity between the No.87 and No.30 terminals when power is disconnected.

Terminal	30	87	85	86
Power				
Disconnected			○—○	
Connected	○—○		—	+

ADJUSTMENT

HEAD LAMP AIMING INSTRUCTIONS

The head lamps should be aimed with the proper beam-setting equipment, and in accordance with the equipment manufacturer's instructions.

NOTE

If there are any regulations pertinent to the aiming of head lamps in the area where the vehicle is to be used, adjust so as to meet those requirements.

Alternately turn the adjusting gear to adjust the head lamp aiming. If beam-setting equipment is not available, proceed as follows :

1. Inflate the tires to the specified pressure and remove any loads from the vehicle except the driver, spare tire, and tools.
2. The vehicle should be placed on a flat floor.
3. Draw vertical lines (Vertical lines passing through respective head lamp centers) on the screen.
4. With the head lamp and battery in normal condition, aim the head lamps so the brightest portion falls on the vertical lines. Make vertical adjustments to the lower beam using the adjusting wheel.

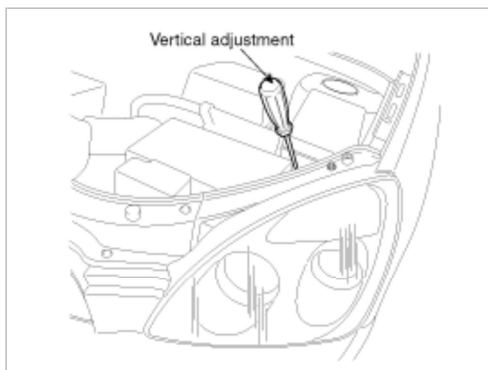

FRONT FOG LAMP AIMING

The front fog lamps should be aimed as the same manner of the head lamps aiming.
 With the front fog lamps and battery normal condition, aim the front fog lamps by turning the adjusting gear (A).

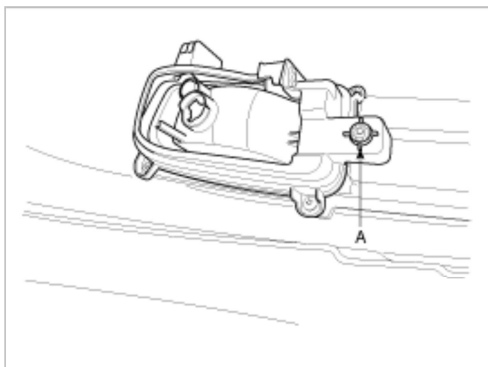

HEAD LAMP AND FOG LAMP AIMING POINT

H1 : Height between the head lamp bulb center and ground (Low beam)
 H2 : Height between the head lamp bulb center and ground (High beam)
 H3 : Height between the fog lamp bulb center and ground
 W1 : Distance between the two head lamp bulbs centers (Low beam)
 W2 : Distance between the two head lamp bulbs centers (High beam)
 W3 : Distance between the two fog lamp bulbs centers
 L : Distance between the head lamp bulb center and screen

Unit : in(mm)

Vehicle condition	H1	H2	H3	W1	W2	W3	L
Without driver	29.2(742)	29.0(737)	18.7(476)	57.0(1,449)	46.8(1,189)	53.2(1,351)	118.1(3,000)
With driver	29.0(739)	28.8(733)	18.6(472)				

1. Turn the low beam on with driver.
 The hot-point should be projected in the allowable range (shaded region).

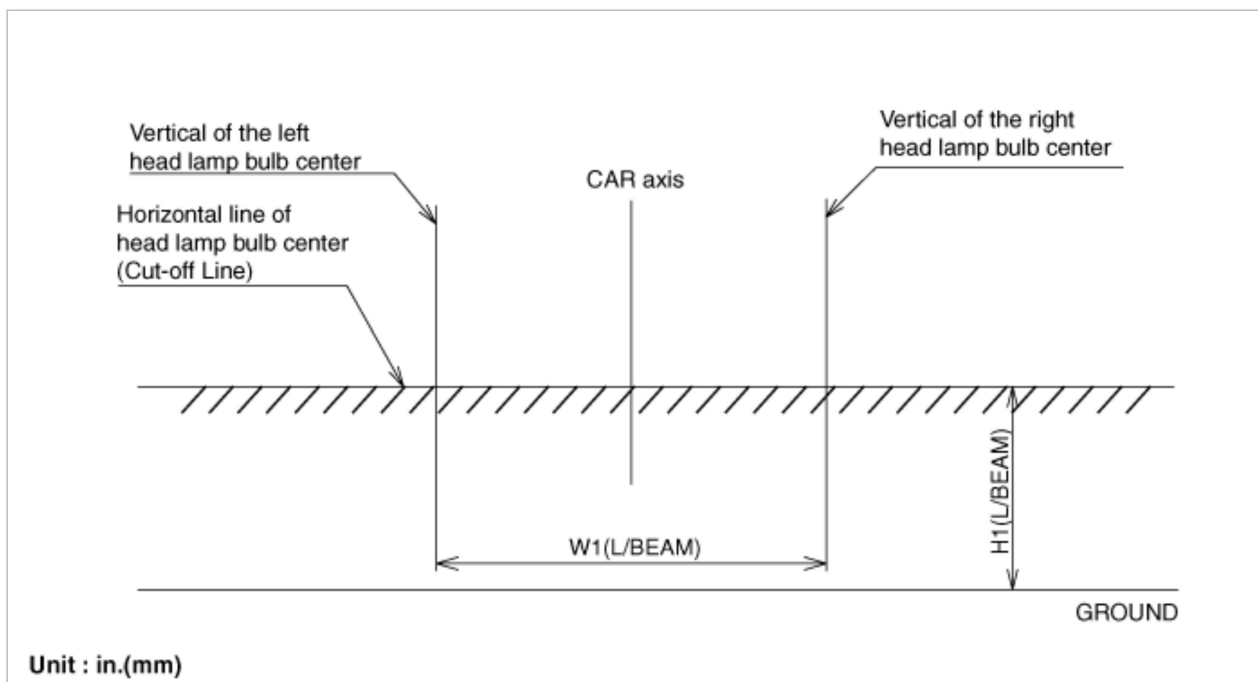

- Turn the front fog lamp on with driver.
The cut-off line should be projected in the allowable range (shaded region)

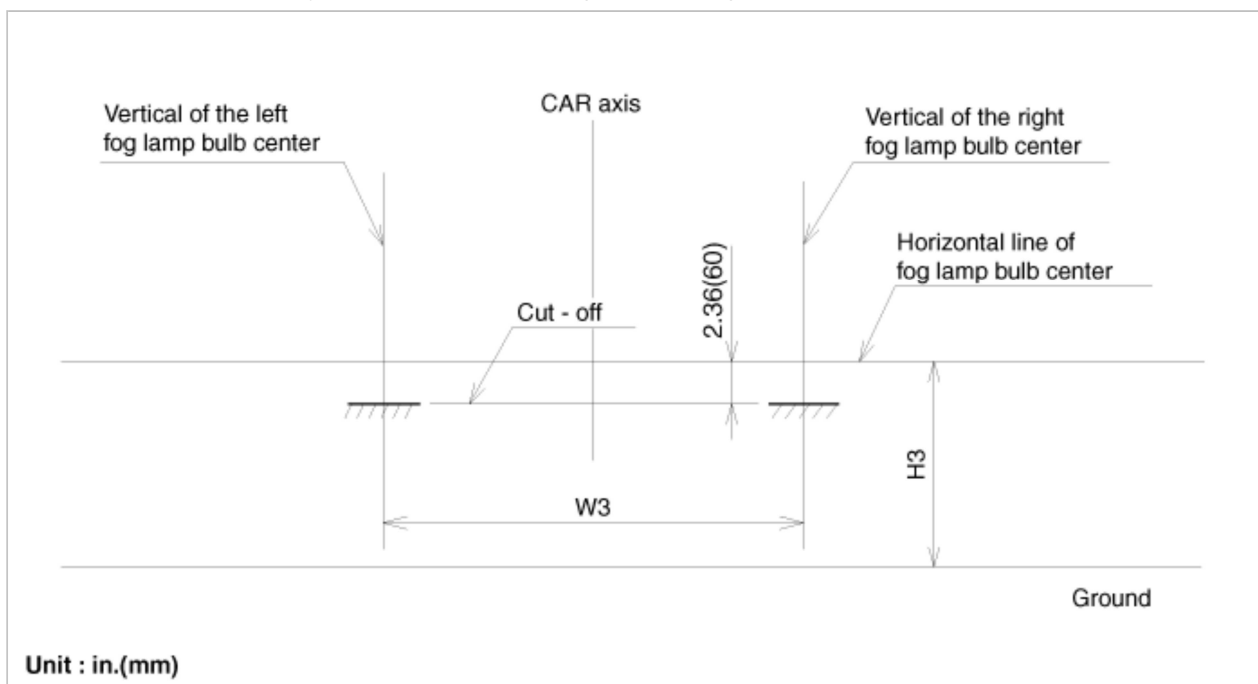

REMOVAL

- Disconnect the negative (-) battery terminal.
- Loosen the mounting bolts (2EA) of head lamp. Remove the head lamp assembly (A) after disconnecting the lamp connectors.

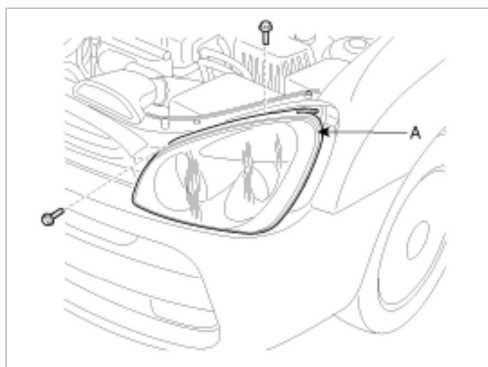
**NOTE**

Take care that retaining clip (A) is not to be damaged.

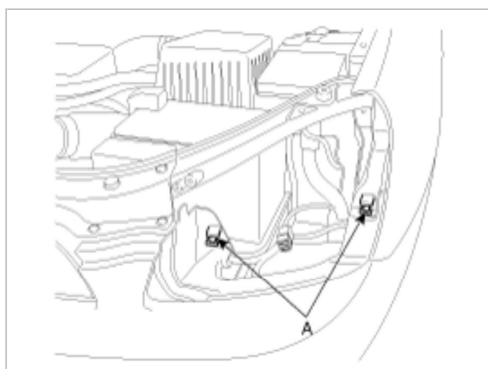

3. Remove the bulb caps(A) from the head lamp assembly.

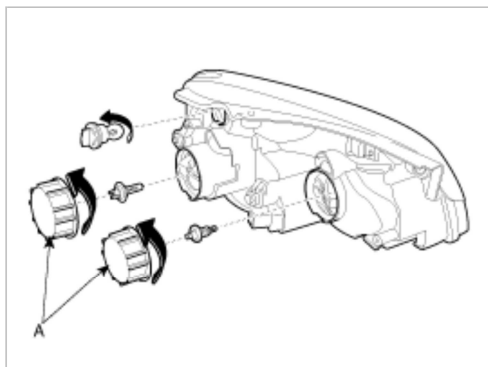

4. Remove the head lamp bulbs(B).

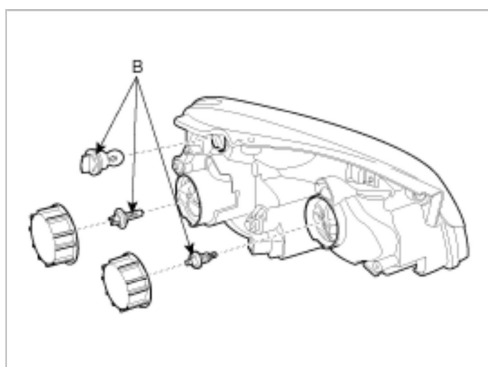
**INSTALLATION**

1. Install the head lamp bulbs.
2. Install the head lamp bulb caps.
3. Install the head lamp assembly after connecting the lamp connector.