

**RONDO(UN) >2012 > G 2.4 DOHC > Brake System****Removal**

1. Remove the brake hose bolt (B) and the guide rod bolts (C) from the caliper assembly (A).

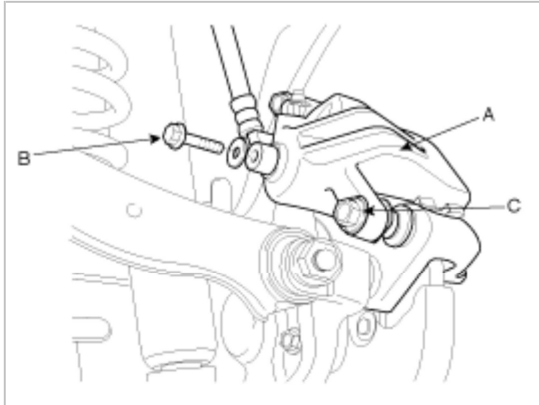

2. Remove the caliper assembly (A).

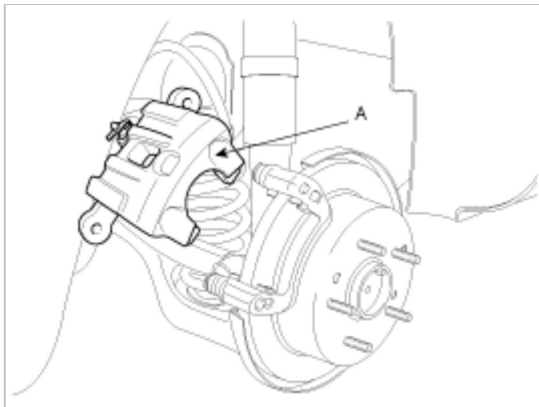

3. Remove the pads (B), the pad shims (C) and the pad retainers (D) from the caliper bracket (A).

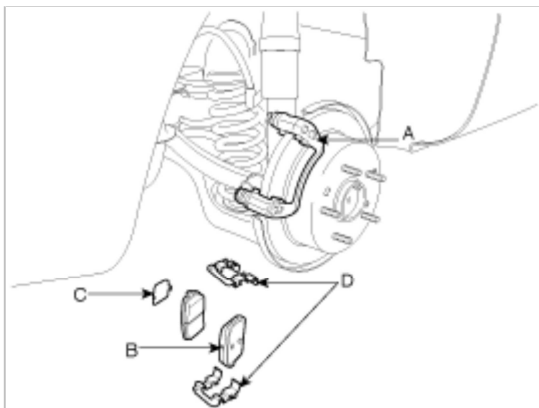

4. Remove the rear upper arm (A).

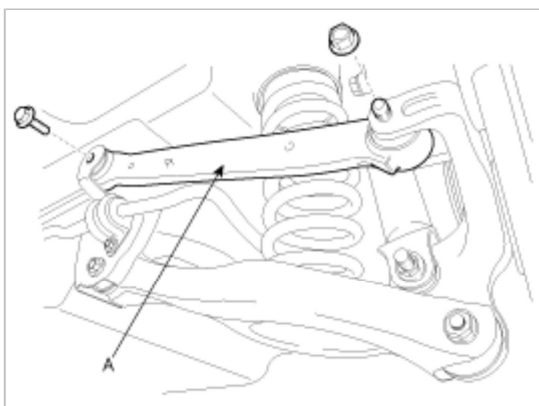

5. Remove the caliper bracket (B) and the caliper mounting bolts (A).

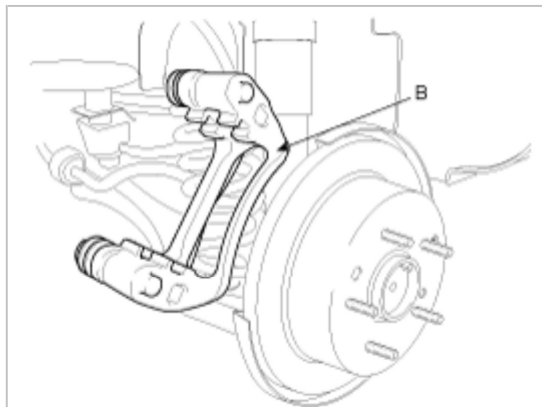
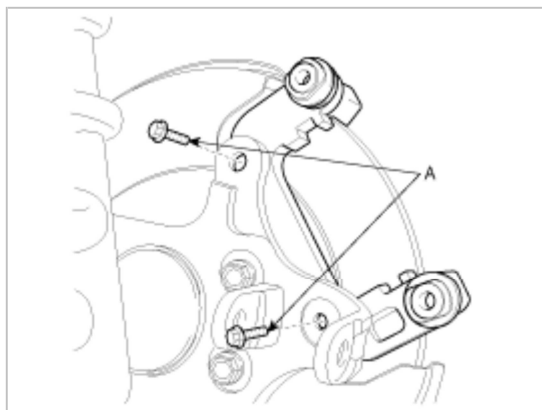

6. Remove the brake disc (A) and the screw (B).

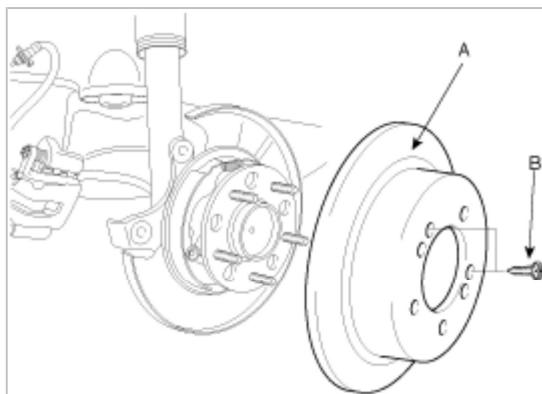
**NOTE**

Remove the brake disc from hub using M8 bolt (A) if the brake disc has been seized with the hub due to corrosion or overheat.

Be careful not to use the hammer. The disc can be damaged if you remove the disc from the hub by hammer.

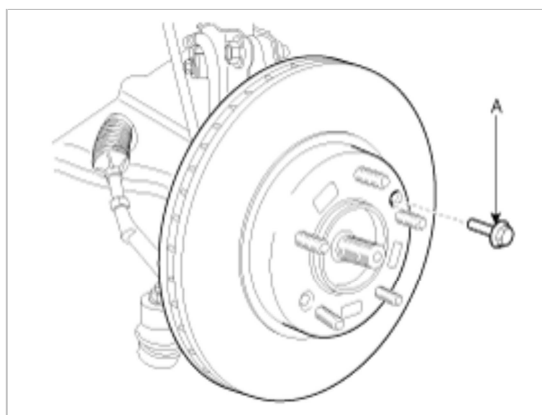

## Replacement

### CAUTION

Frequent inhalation of brake pad dust, regardless of material composition, could be hazardous to your health.

- Avoid breathing dust particles.
- Never use an air hose or brush to clean brake assemblies.

1. Remove guide rod bolt (B) and raise the caliper assembly (A).

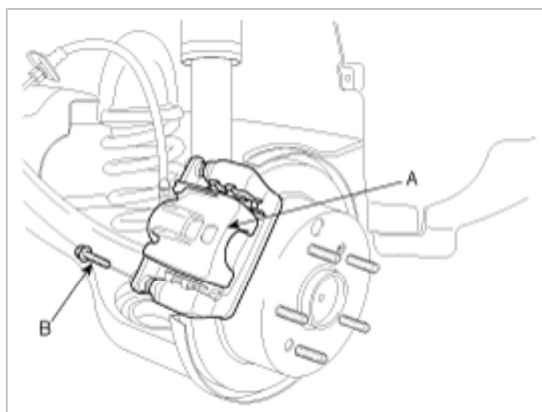

2. Remove the pads (B), the pad shims (C) and the pad retainers (D) from the caliper bracket (A).

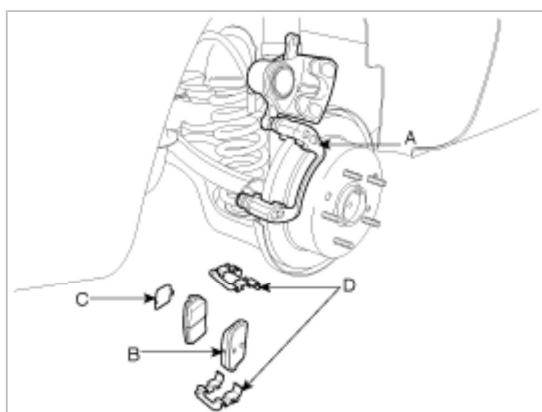

## Inspection

### Rear Brake Disc Thickness Check

1. Remove all rust and contamination from the disc surface, and then measure the disc thickness at 8 positions at least.

---

#### Rear brake disc thickness

Standard value : 10.0 mm (0.39 in)

Limit : 8.0 mm ( 0.31 in)

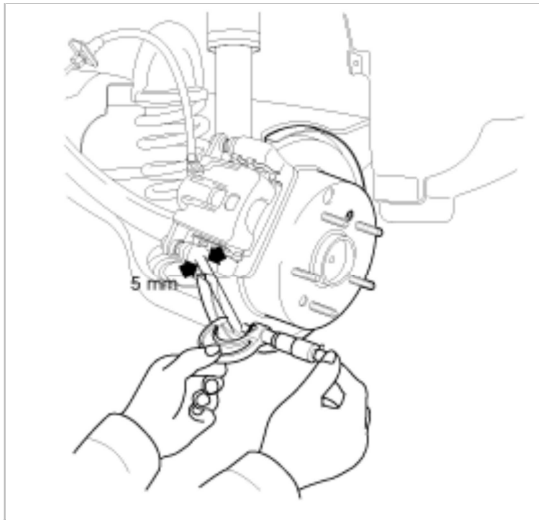

2. Thickness variation should not exceed 0.005 mm (0.0002in) (circumference) and 0.01 mm(0.0004 in) (radius) at any directions.
3. If wear exceeds the limit, replace the discs and pad assemblies for left and right of the vehicle.

### Rear Brake Pad Check

1. Check the pad wear. Measure the pad thickness. replace it if it is less than the specified value.

#### Pad thickness

Standard value : 10.0 mm (0.39 in)

Service limit : 2.0 mm (0.0787 in)

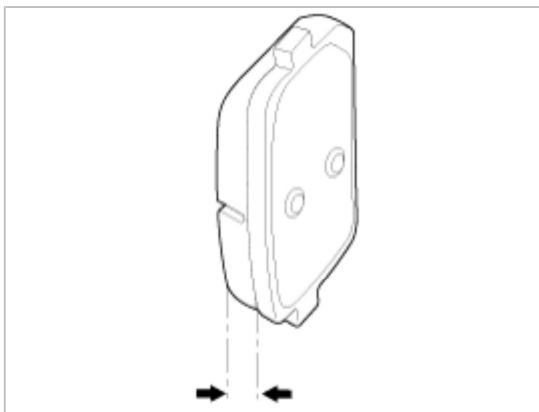

2. Check that grease is applied, to sliding contact points and the pad and backing metal for damage.

### Rear Brake Disc Run Out Check

1. Place a dial gauge about 5mm (0.2 in) from the outer circumference of the brake disc, and measure the run out of the disc.

#### Brake disc run out

Limit : 0.05 mm (0.0020 in) or less

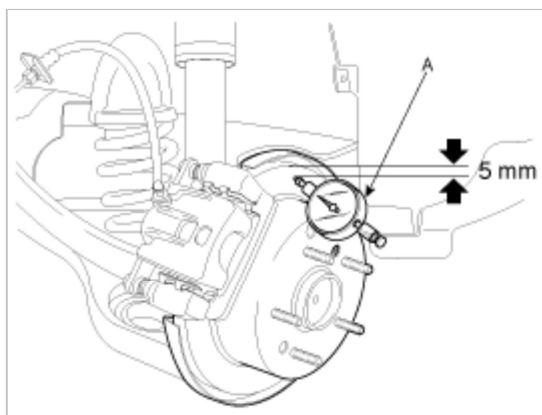

2. If the run out of the brake disc exceeds the limit specification, replace the disc, and then measure the run out again.
3. If the run out does not exceed the limit specification, install the brake disc after turning it and then check the run out of the brake disc again.
4. If the run out cannot be corrected by changing the position of the brake disc, replace the brake disc.

### Installation

1. Install the brake disc (A) and tighten the screw (B).

Tightening torque : N.m (kgf.m, lb-ft)  
4.9~5.9 (0.5~0.6, 3.6~4.3)

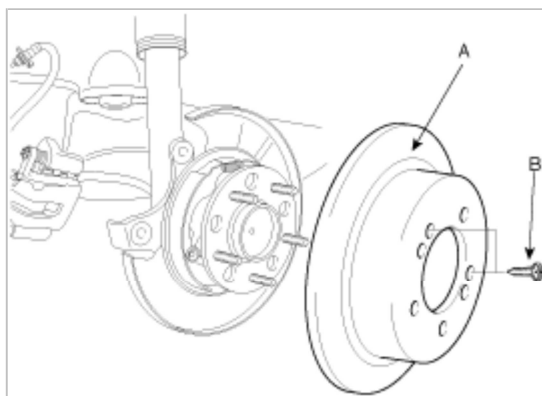

2. Install the caliper bracket (B) and tighten the caliper mounting bolts (A).

Tightening torque : N.m (kgf.m, lb-ft)  
49.0~58.8 (5.0~6.0, 36.2~43.4)

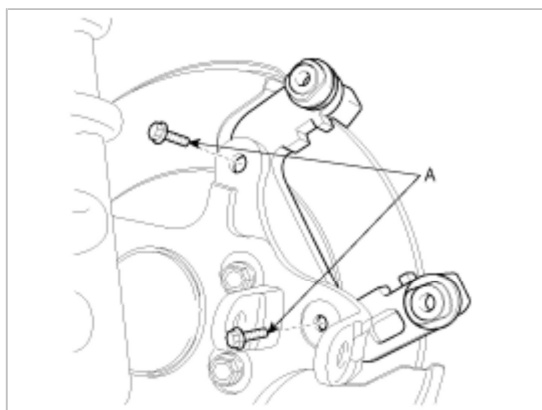

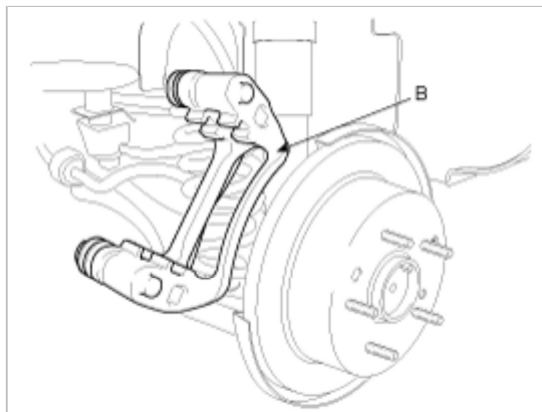

3. Install the rear upper arm (A).

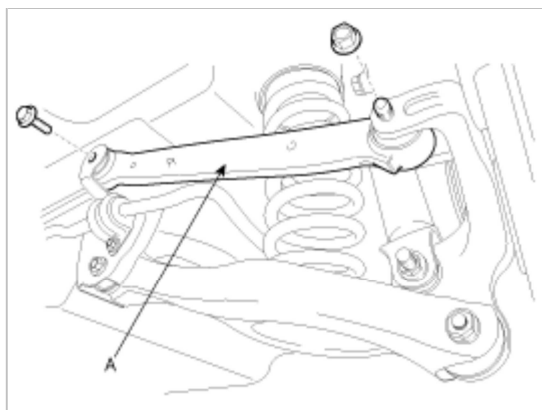

4. Install the pad retainers (D) to the caliper bracket (A).
5. Install the brake pads (B) and pad shims (C) on the pad retainer correctly. Install the pad with the wear indicator on the inside. If you are reusing the pads, always reinstall the brake pads in their original positions to prevent a momentary loss of braking efficiency.

**NOTE**

Check the foreign material at the pad shims (A) and the back of the pads (B). Contaminated brake discs or pads reduce stopping ability. Keep grease off the discs and pads.

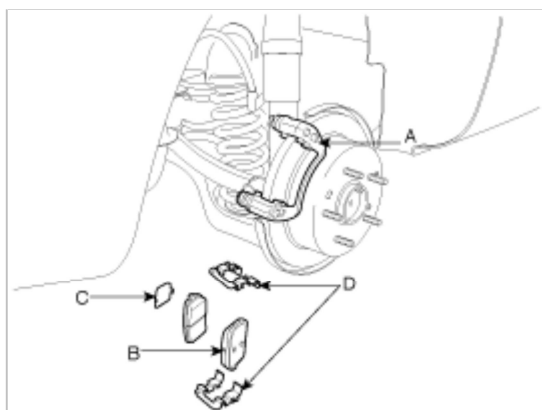

6. Push in the piston using the SST(09581-11000) so that the caliper will fit over the pads. Make sure that the piston boot is in position to prevent damaging it when installing the caliper.

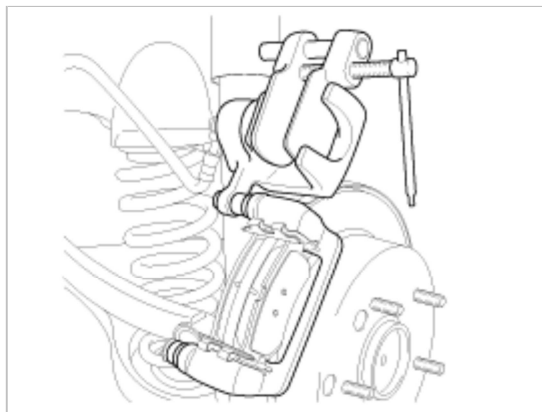

7. Install the caliper assembly (A).

**NOTE**

Be careful not to damage the piston pin boot.

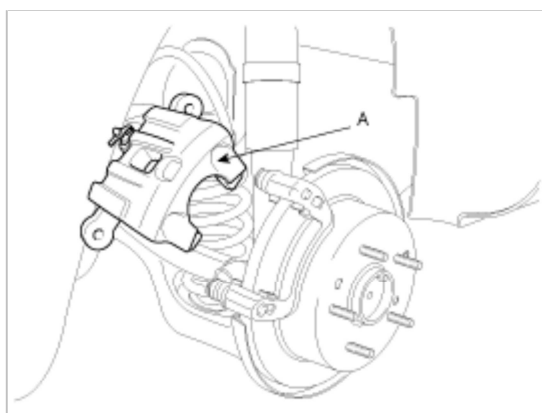

8. Install the brake hose bolt (B) and the guide rod bolts (C) to the caliper assembly (A).

Tightening torque : N.m (kgf.m, lb-ft)

Bolt (B) : 24.5~29.4 (2.5~3.0, 18.1~21.7)

Bolt (C) : 21.6~31.4 (2.2~3.2, 15.9~23.1)

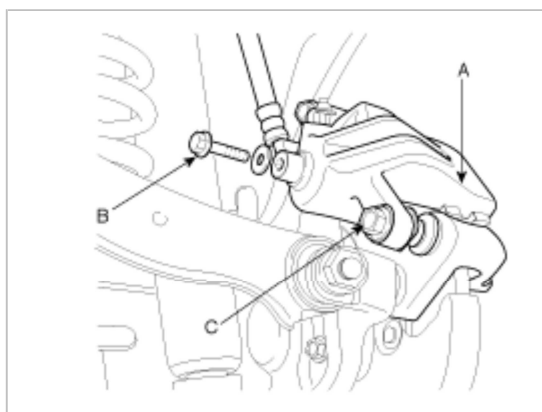

9. Refill the master cylinder reservoir to the MAX line.

10. Bleed the brake system. (Refer to "Bleeding of brake system")

11. Depress the brake pedal several times to make sure the brakes work, then test-drive.

**NOTE**

Engagement of the brake may require a greater pedal stroke immediately after the brake pads have

been replaced as a set. Several applications of the brake will restore the normal pedal stroke.

12. After installation, check for leaks at hose and line joints or connections, and retighten if necessary.